



Installation & Commissioning Manual

CSI-GL-LAN-STICK



Introduction

This Data Logger LAN Stick is used to relay CSI Inverter data to CSI cloud data monitoring app platforms – CSI Cloud & CSI Cloud Pro. Users can easily check device information by logging in to either of these platforms. The communication topology is as shown below...

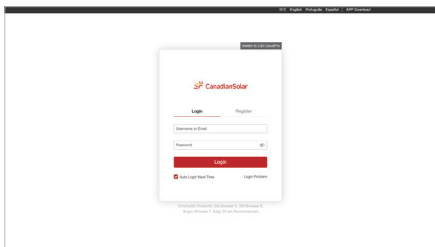
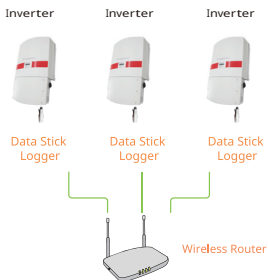

To ensure normal use of the device, before using the device, be sure that:

- The connected wireless router has uninterrupted internet access.
- The communication address of the inverter MUST BE "01", which is default value.
- A laptop computer are connected to this device for parameter setting.

Electrical Connection

Connect the LAN stick to the communication port on the underside of the inverter, and connect Ethernet cable from LAN Stick to router.



Groove

Data Logger LAN Stick Interface

Data Logger LAN Stick Installation

Insert LAN Stick to COM port.
Fasten the LAN Stick.

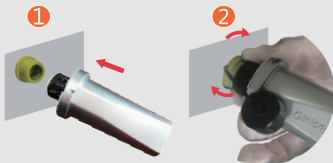



Attention!!!

The device must be kept away from large metal objects and any electrical device with strong magnetic fields, such as a microwave oven, refrigerator, cordless phone, and PV panel. This will ensure adequate communication quality. Communication quality can also be affected by thick walls, concrete and lightning.

APP USER MANUAL

Download APP



CSI Cloud
for end user



CSI CloudPro
for business

1. Registration

Click [Register] to create new account. Use your email to register.

English ▾

CSI Cloud

E-mail Phone Username

E-mail E-mail

Password Password

[Forgot password](#)

Log In

Log In

Register

< Register

E-mail Phone

E-mail E-mail

Verification Code [Send](#)

Next

2. Create Plant

2.1 Click [Add Now] to create a plant. Proceed as described below.

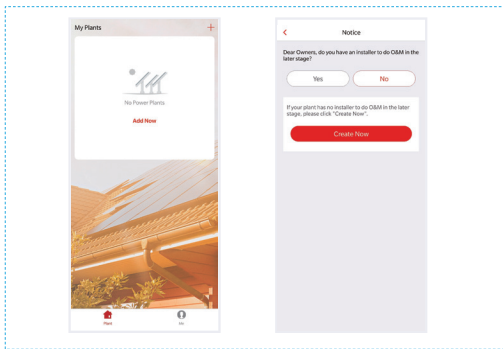

2.2 Confirm the location of the plant and complete the related details on the next page, and then click [Finish] to complete the plant.

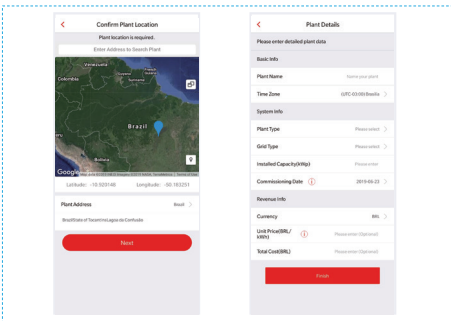

2.3 Now you can see the plant you just created on the home page. Click the [Check the plant] button to view detailed data for the plant.

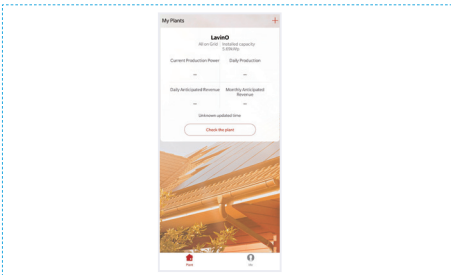

3. Add a device

3.1 Click the [+] button in the upper right corner of the home page, select [Add a Logger], and select the plant where you want to add the device in the next page.

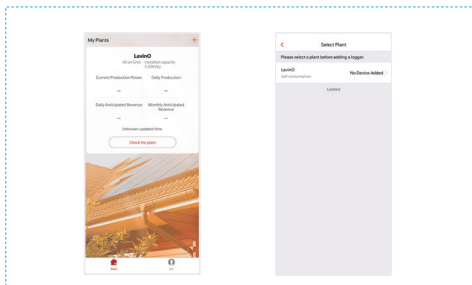

3.2 You can choose to scan the barcode of the collector or directly enter the SN number below the barcode to add it, then click the [Add] button to go to the next page.

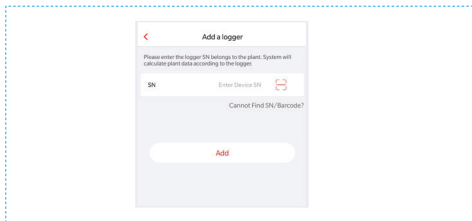

3.3 On this page, you can stipulate how the logger selects the device associated with it. The default mode is “Automatic Selection”. If you do not have special requirements, please click the [Done] button to confirm. After the confirmation is completed, the logger will be added to the plant.

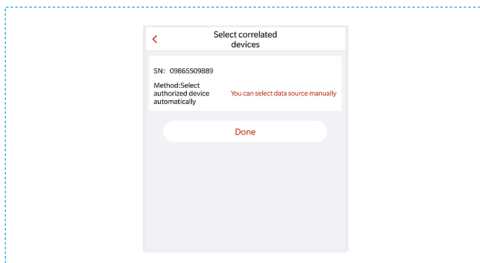



Warning: Please ensure the data logger is working properly before leaving the site. If issues arise, contact customer service immediately.

If you have any technical queries about our products, please contact us and provide the following information:

1. Product model and serial number of data logger.
2. Product model and serial number of connected inverter.

Thank you for your support and cooperation!



CANADIAN SOLAR INC.

545 Speedvale Avenue West, Guelph, Ontario N1K 1E6, Canada | www.canadiansolar.com