

Product key:

JA3 (or JZ3) - SB - D x L / Lg + FZD (or E16)

D = diameter of screw (lower part)

L = length of screw (lower part)

Lg = length of setscrew (upper part)

JZ3 = thread type for steel substructures

JA3 = thread type for wood substructures

Standard is a $\varnothing 5/16"$ (8mm) fastener with M10x1.969" (50mm) setscrew; the length L is variable and has to be chosen according to the respective project.

General:

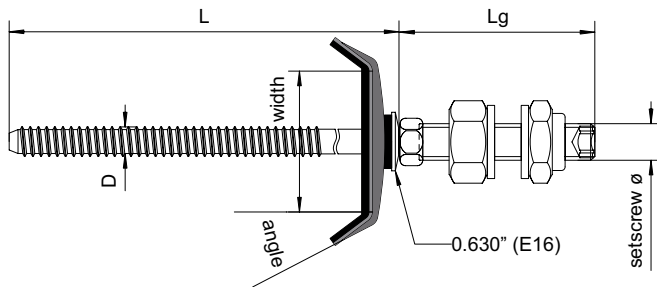

Example:

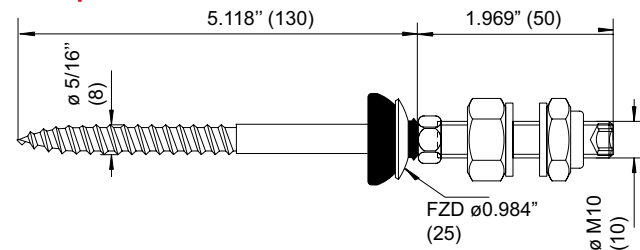

7.3 inches EJOT Solar Fastening System for wood substructure

Code: JA3-SB-8.0 x 130/50 FZD

(in inches: JA3-SB-5/16" x 5.118"/1.969" FZD)

Your advantages:

- Labor saving installation
- The installation is very secure through the transfer of tensile loads and pressure forces directly into the substructure
- A solar installation can easily be mounted on an existing roof – the old screws can be replaced with the EJOT Solar Fastening Systems, using the existing holes
- Minimum risk of leakage problems
- The installer cannot change the predefined fastener setup which avoids the alteration/elimination of important quality and performance characteristics
- Competent consulting services
- Application engineering and technical support
- Flexibility regarding special requests
- Short lead-time from North American inventory shipped on a Just-In-Time (JIT) basis
- Products made of stainless steel grade 304 (A2)

Our engineering department would like to assist you in choosing the appropriate EJOT product for your project. Please call us at +1 262-612-35 50 or send an e-mail to info@ejot-usa.com.

EJOT Authorized Distributor:

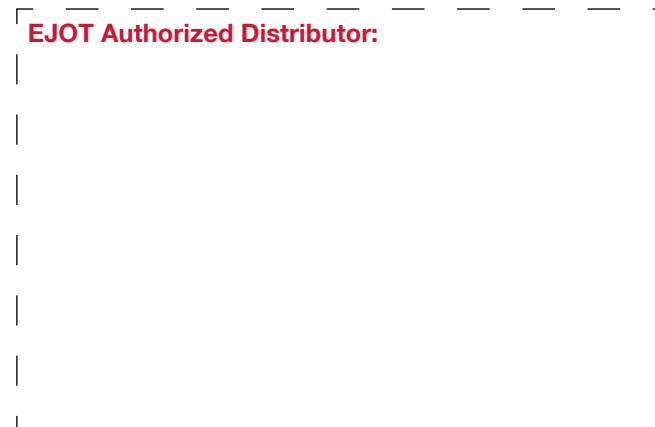

EJOT Fastening Systems LP

9900 58th Place, Suite 100, Kenosha, Wisconsin 53144 USA

Phone: +1 262-612-35 50, Fax: +1 262-721-12 45

info@ejot-usa.com, www.ejot-usa.com



EJOT® Solar Fastening Systems JA3 & JZ3

For PV installations on exposed fastener metal panel roofs



EJOT® Solar Fastening Systems JA3 & JZ3

Offer:

- Solution for rooftop PV and solar thermal installations on commercial, industrial and agricultural buildings
- Simple and secure installation process
- Reduced installation time
- Highly engineered thread-form that fastens in metal and wood substructures
- Precise defined depth (control) stop that allows a preliminary project-related calculation incl. fastener positioning scheme
- Design that includes a proven sealing system for metal roofs
- Minimum risk of material damage problems
- Secure and repeatable installation results
- Applicability to all common mounting systems and strut rails
- High product quality through strict quality controls
- Very secure fixing through fastening directly into the substructure
- Technically approved fastening system
- Perfect adjustment to your project
- **The EJOT Solar Fastening System is NOT a hanger bolt!**

Variants:

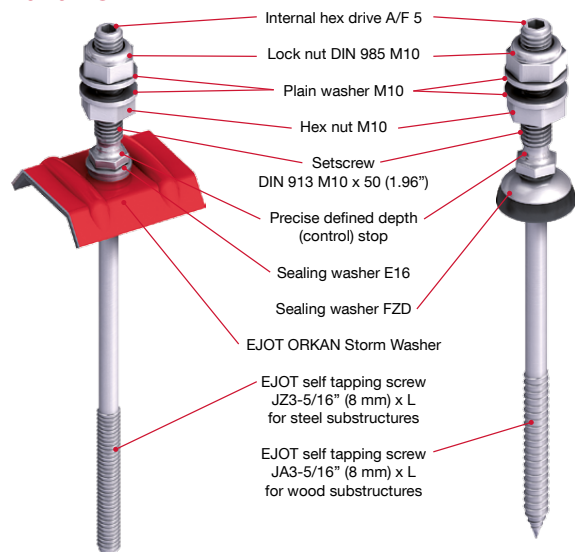

Applications range:

Roof coverings:

Trapezoidal metal profiles

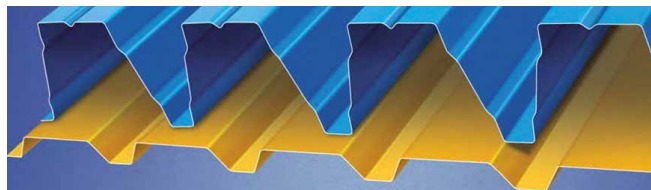

Insulated metal panels



Corrugated metal profiles

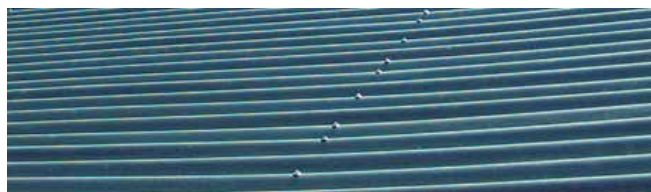

Substructure:

Wood substructure



Steel substructure



Variants:

Sealing:

Sealing element FZD (standard solution)

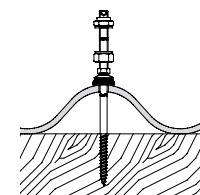

Applications:

- Trapezoidal metal sheets
- Corrugated metal sheets
- Sandwich panels
- Rough surfaces

Sealing washer + EJOT ORKAN Storm Washer (customized solution for special projects)

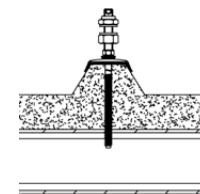

Applications:

- Trapezoidal metal sheets
- Corrugated metal sheets
- Sandwich panels

Fastening:

JA3 thread for wood substructure



JZ3 thread for steel substructure

